

TAB SIZE	6,3 x 0,80
WIRE SIZE	2,50-6,00 mm <sup>2</sup>
MATERIAL	CuZn
PLATING	-
MAXIMAL TEMPERATURE	110 °C

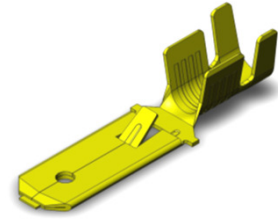

**TEST RESULTS**

**INSERTION / WITHDRAWAL FORCE**

	1. INSERTION	1. WITHDRAWAL	6. WITHDRAWAL
TS EN 61210	-	-	-
HATKO	-	-	-
Typical Values	-	-	-

**CRIMP DATAS**

**CRIMP PULL-OUT FORCE**

	1. PULL OUT FORCE		
	2,50 mm <sup>2</sup>	4,00 mm <sup>2</sup>	6,00 mm <sup>2</sup>
TS EN 61210	230 N min	310 N min	360 N min
HATKO	230 N min	310 N min	360 N min
Typical Values	311 N	317 N	391 N

**CRIMP MEASUREMENTS**

	HEIGHT		WIDTH	
	WIRE	INSULATOR	WIRE	INSULATOR
2,50 mm <sup>2</sup>	2,00 ±0,04	3,80 ±0,05	4,08 ±0,05	5,10 ±0,05
4,00 mm <sup>2</sup>	2,14 ±0,04	3,93 ±0,05	4,10 ±0,05	5,10 ±0,05
6,00 mm <sup>2</sup>	2,25 ±0,04	4,12 ±0,05	4,12 ±0,05	5,12 ±0,05

**CURRENT VALUES**

	CURRENT CARRYING CAPACITY	MAX. CONTACT RESISTANCE
	Max. A	WITH MIN.WIRE SIZE (mΩ)
2,50 mm <sup>2</sup>	26	-
4,00 mm <sup>2</sup>	29	-
6,00 mm <sup>2</sup>	32	-

PREP.: TURAN KELEŞ

CON.: HÜSEYİN DOĞAN